

Thank you for choosing InsulCheck.

- InsulCheck clips on in seconds to your insulin pen.
- Once your InsulCheck is assembled correctly, you continue to inject as normal without any additional steps.
- When injection is completed, the confirmation LED will blink and the display will reset to 00:00 and then start counting up (the device will count seconds up to the first minute).
- The large easy to read display shows the elapsed time since you last injected.
- Now with a replaceable battery, your InsulCheck will give you years of peace and comfort.

DISCLAIMER

- Use for confirming **time of last injection** only. Not to be used to determine dosage.
- The InsulCheck timer requires a minimum injection dosage to operate successfully on some pens. Please see: www.insulcheck.com/supported-pens.
- For guidance with diabetes always consult your doctor.

Using Your InsulCheck

Your InsulCheck comes in two parts: the timer which contains the electronics and the pen specific sleeve that attaches to your pen.

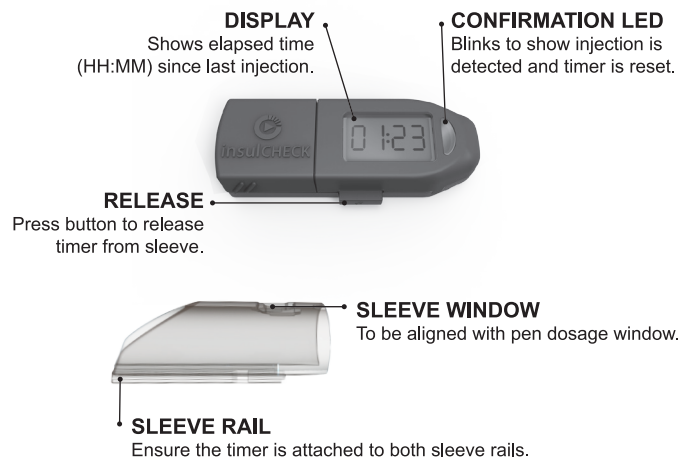

FITTING YOUR INSULCHECK ONTO YOUR PEN:

1

Lining Up the Sleeve:

Make sure you have the appropriate sleeve for your pen by checking the box the device came in. Align the sleeve window with pen dosage window.

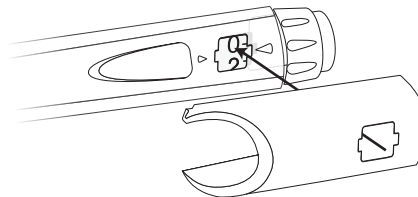

2

Mounting the Sleeve:

Press the sleeve down on the insulin pen.

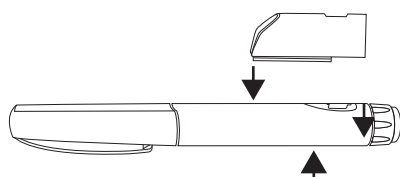

- 1) Ensure the sleeve is orientated correctly.
- 2) Align sleeve window with dosage window.
- 3) Push, click and rotate the sleeve until it locks firmly to the pen dosage window.

3

Activating InsulCheck Timer:

To activate your InsulCheck for the first time, remove the cover and insert a 3.0V CR1225 model battery to activate.

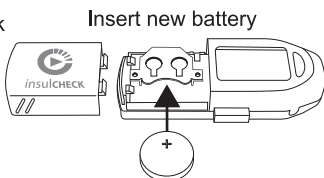

Display will light up and flash.
Your device is now active.

4

Attaching the Timer:

- 1) Align the timer and slide onto sleeve.

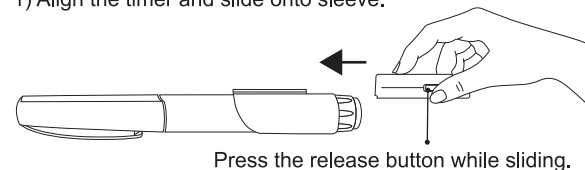

- 2) Ensure the timer slides onto both rails of the sleeve. Push firmly in the direction shown.

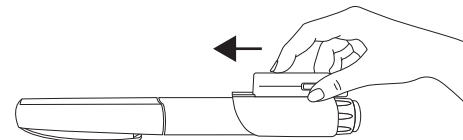

- 3) Slide the timer until it is fully mounted. When positioned correctly, the timer will click and lock firmly onto pen.

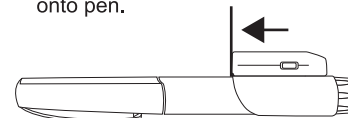

SLEEVE CHECKLIST

Check Sleeve Alignment:

Check that the sleeve is lined up exactly with the edge of the pen.

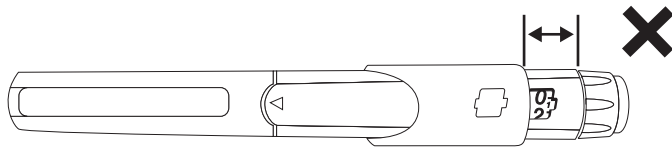

Rotate the sleeve if not aligned with the dosage window.

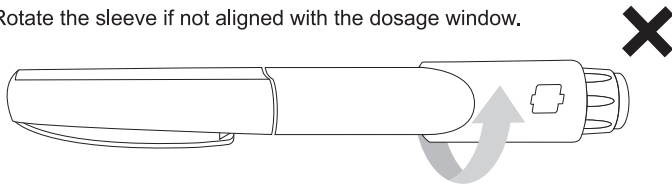

Check that the sleeve window is aligned correctly.

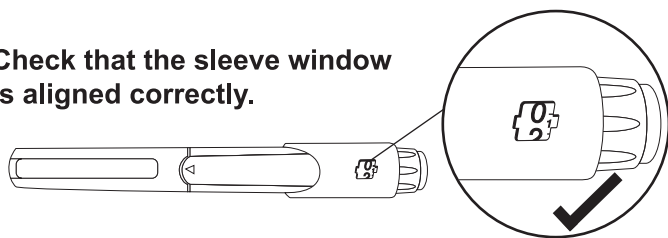

TIMER CHECKLIST

1) When Mounted Correctly:

- If after assembly, or on injection completion, your InsulCheck display does not flash or the green light does not blink, check if it is mounted correctly and reassemble using the instructions provided.
- If the problem persists, your InsulCheck may be faulty and you should return it for a replacement.

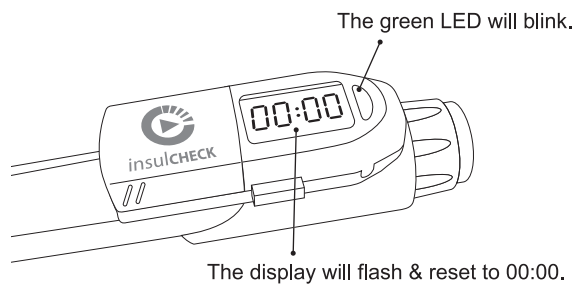

2) Timer Fitting:

Check that the timer is attached to both rails of the sleeve.

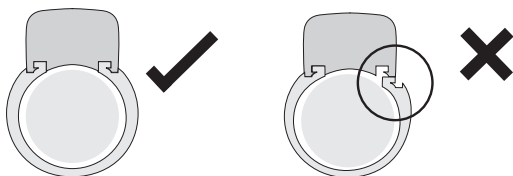

3) Timer Fitting:

Make sure that the timer is fully mounted onto the sleeve.



ADDITIONAL INDICATORS

In addition to the time since last injection, your InsulCheck might display the following warnings:

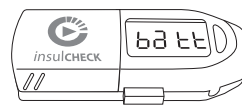

Please change the battery.

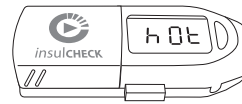

The device has been exposed to high temperatures since last injection.

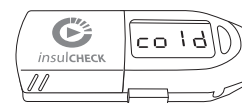

The device has been exposed to low temperatures since last injection.

Important note: The temperature indicators are only showing the temperatures to which the pen has been exposed since last injection, not the current temperature of the drug. The indicator will disappear after the next injection.

DEVICE REMOVAL

- 1) Press and hold the release button at the side of the timer.
- 2) Pull firmly in the direction shown and the InsulCheck timer will slide from sleeve rails.

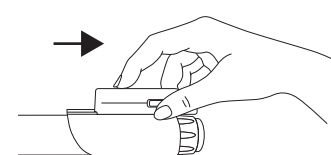
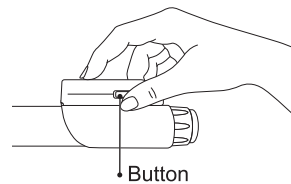

- 3) To release the sleeve, grasp and pull it upwards from the pen.

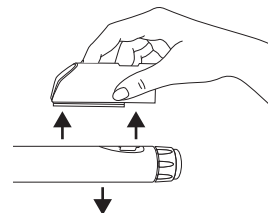
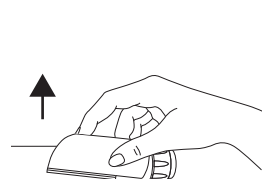

CHANGING BATTERY

If the display is faint / the LED is dim / LED does not blink, the battery may be flat. The recommended battery is a **3.0V CR1225** button cell or equivalent.

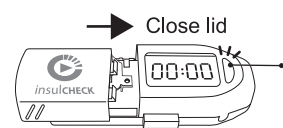
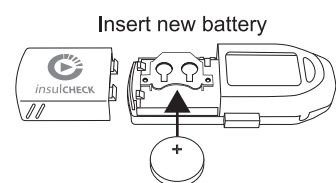
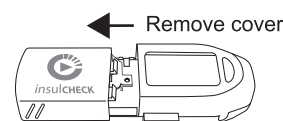

Display should light up and LED Blink